



ADVANCED
SHIPBUILDING

CATALOG MULTIHULL SAILING YACHTS



Introduction:

This catalog is an indication of possible models of multihull sail yachts. There are hundreds of makes and sizes. This selection has been made to give you an idea of what exists and is possible. Once you have chosen a certain type of model and size we can also, on demand, look into other makes and their nearby sizes.

Other catalogs:

Catalog of monohull sail yachts

Catalog of motor yachts

Catalog of power boats

Catalog of racing sail yachts



Timmerman Yvon



Timmerman Rene

A small word about multihull sail yachts

While monohulls are the classic type, multihulls are becoming more common as a cruising boat.

The biggest reasons are stability and space. Multihulls have a more stable surface and don't roll from one side to the other like monohulls, making it more stable and comfortable.

Basically there are 2 types of multihull. The catamaran (double hull) is the most common in this class. The trimaran (triple hull) is less common as a cruising boat. The reason for this is space. A trimaran is basically a monohull with 2 floaters attached to it. Those hulls are too small to use as living space and therefore usually empty. They are mainly used in racing. Cruising trimarans are usually of the smaller sportive type.

Another big difference with the monohull is that multihulls are faster due to their tunnel(s) between the hulls. An air cushion builds up underneath the tunnel and lifts the boat, reducing drag making a faster boat.

For cruising, catamarans are the most common due to having more space per length measurement than other types of boats. The reason is it's rectangular shape and both hulls being big enough to hold cabins.

Trimaran:

Catamaran:

Example both 36 foot long

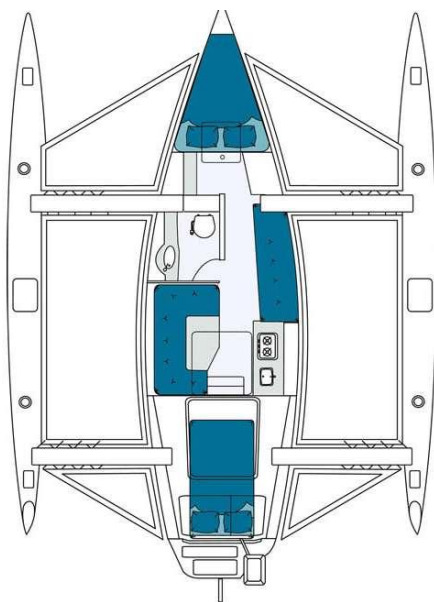

Sport Sail yachts

Corsair 36



LOA: 10.97 m (36')
Draft: 0.51 to 1.83 m (1' 8" to 6') boards up / down
Engine: 20 HP outboard
Cabins: 4 persons in 2 cabins

Beam: 7.80 m (25' 7")
Disp.: 2.495kg (5.500 lbs)

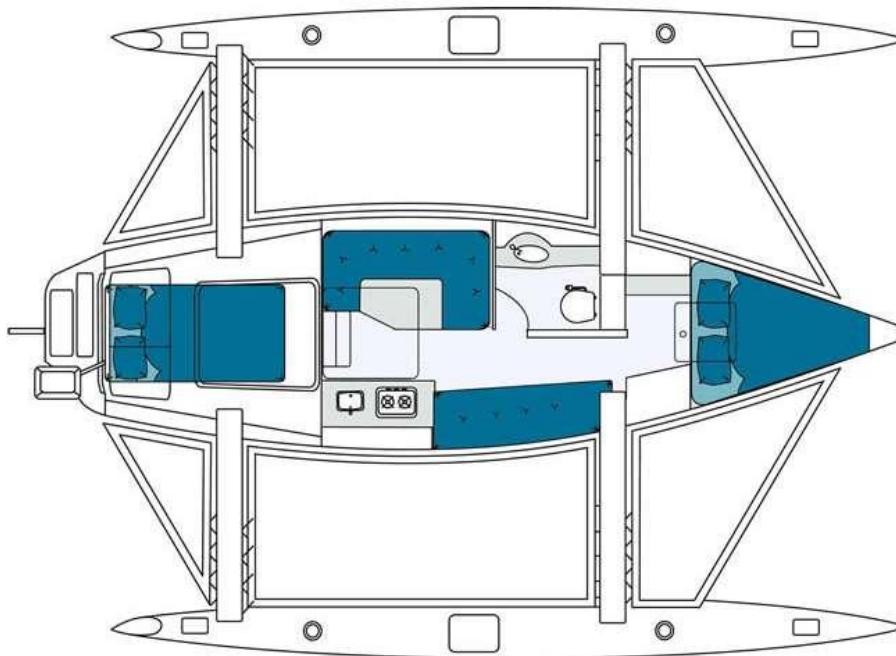



Aft cabin:





Fountain Pajot Mahe 36



LOA: 11 m (36.19')

Draft: 1.10 m (3.62')

Engine: 2 x 20 HP

Cabins: 4 to 6 persons in 2 to 3 cabins

Beam: 5.90 m (19.41')

Disp.: 5.000 kg (11.025 lbs)

Different models:

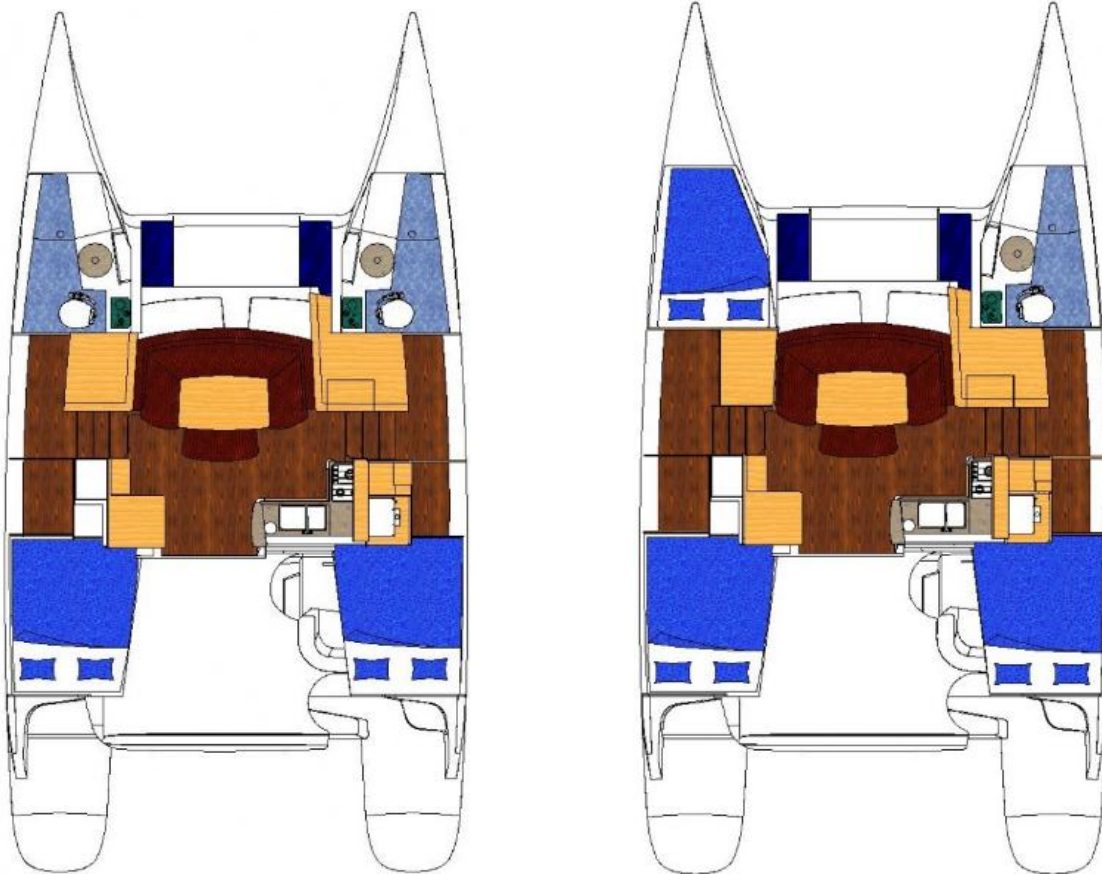





Fountaine Pajot Athena 38



LOA: 11.60 m (38')

Draft: 0.95 m (3')

Engine: 2 x 18 to 30 HP

Cabins: 8 persons in 4 cabins

Beam: 6.30 m (20.7')

Disp.: 5.500 kg (12.125 lbs)

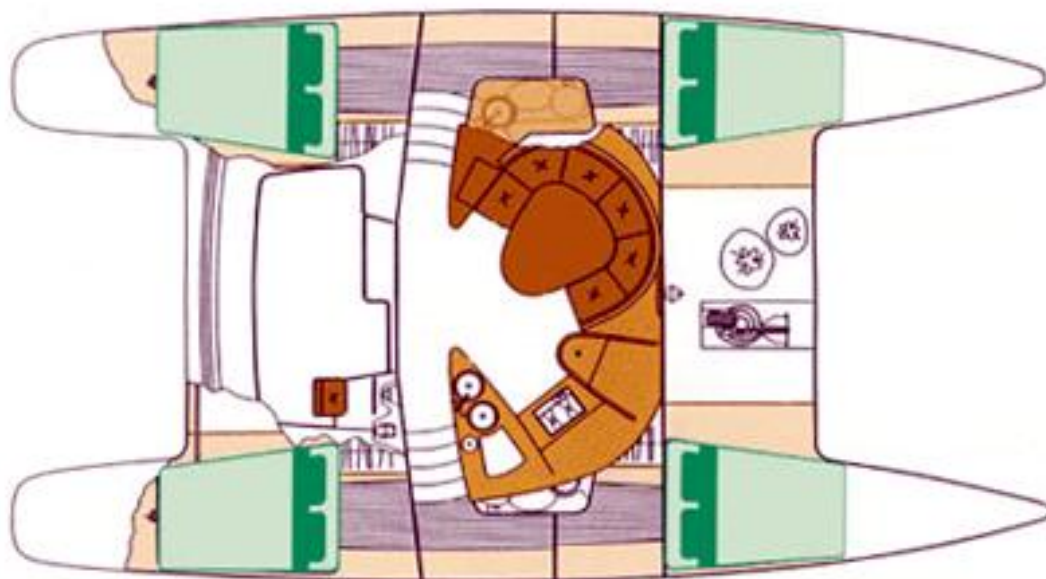





Lagoon 38



LOA: 11.55 m (37' 11")

Draft: 1.15 m (3' 9")

Engine: 2 x 20 HP

Cabins: 6 to 8 persons in 3 to 4 cabins

Beam: 6.30 m (21' 5")

Disp.: 7.260kg (16.000 lbs)

Different models:

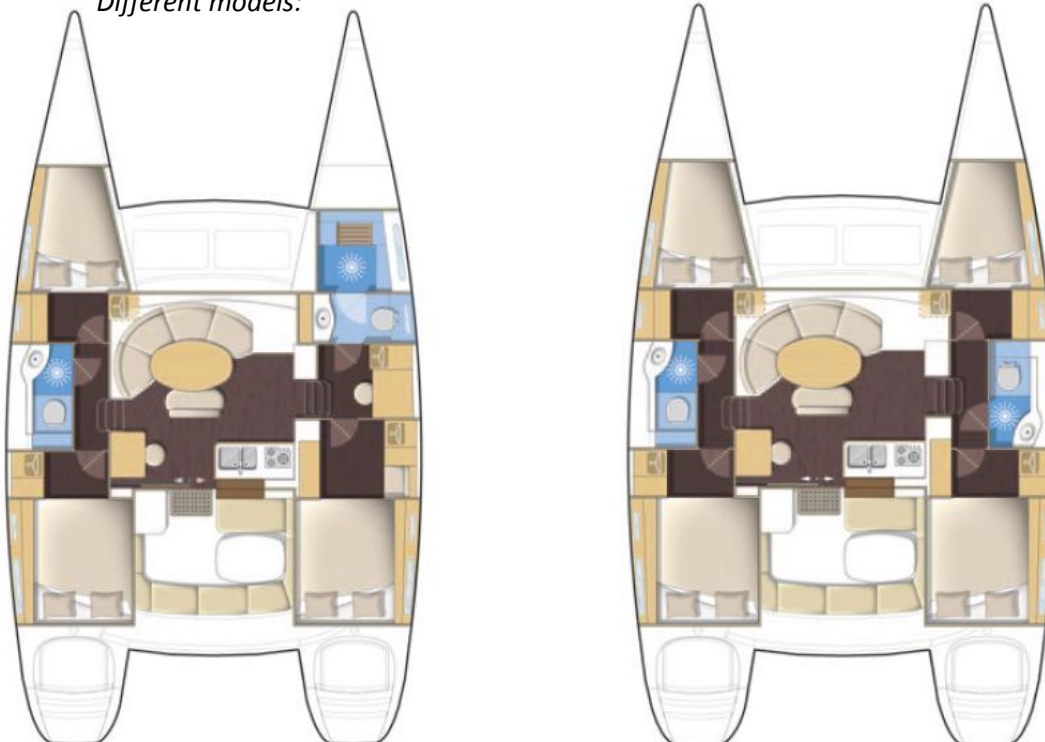







Luxury Sail yachts

Catana 42



LOA: 12.58 m (43')
Draft: 0.60 to 2.70 m (2 to 8.86') board up / down
Engine: 2 x 29 HP
Cabins: 6 to 8 persons in 3 to 4 cabins

Beam: 6.86 m (22.50')
Disp.: 9.300kg (20.502 lbs)

Different models:

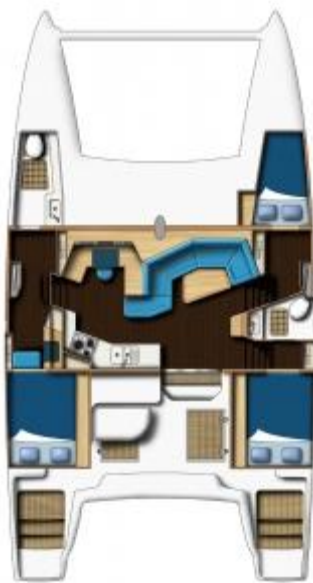









Catana 50



LOA: 15.20 m (50')
Draft: 1.20 to 2.95 m (4 to 9.68') board up / down
Engine: 2 x 54 HP
Cabins: 6 to 8 persons in 3 to 4 cabins

Beam: 7.93 m (26')
Disp.: 13.600 kg (30.000 lbs)

Different models:

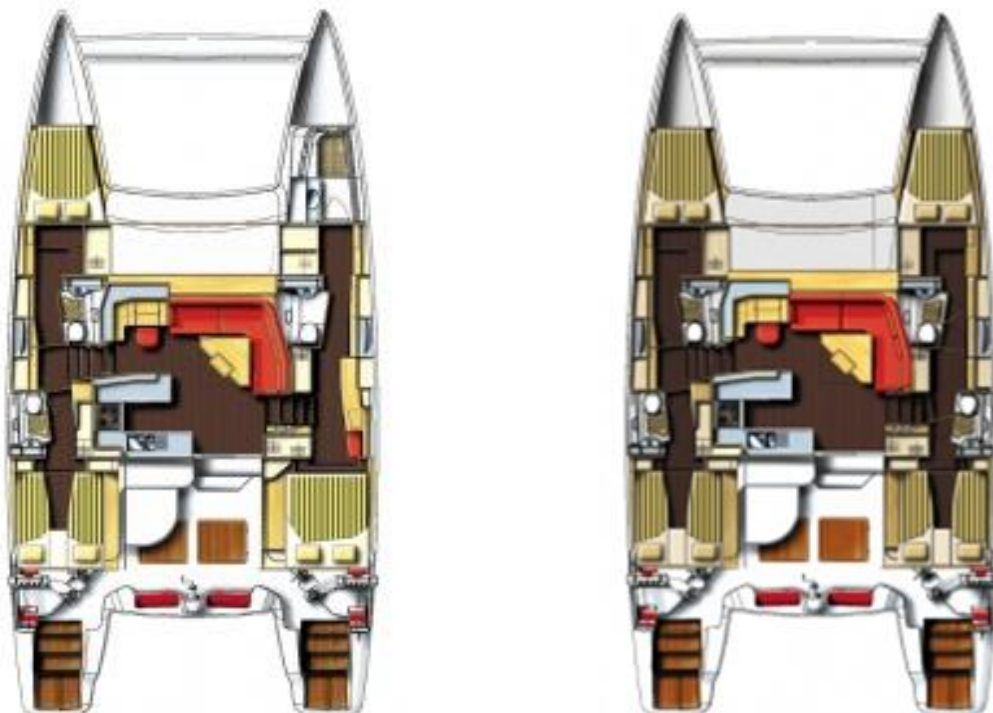







Fountain Pajot Orana 44



LOA: 13.10 m (43')
Draft: 1.10 m (3.94')
Engine: 2 x 30 HP

Beam: 7.35 m (24.11')
Disp.: 9.800 kg (21.600 lbs)
Cabins: 6 to 8 persons in 3 to 4 cabins

Different models:

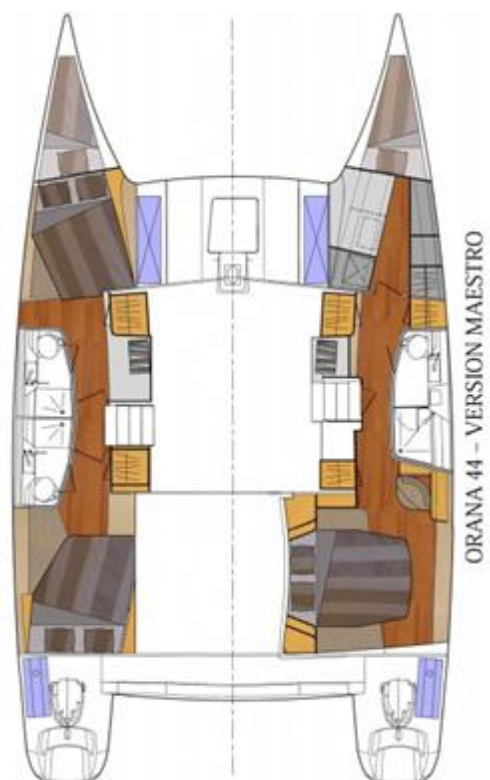
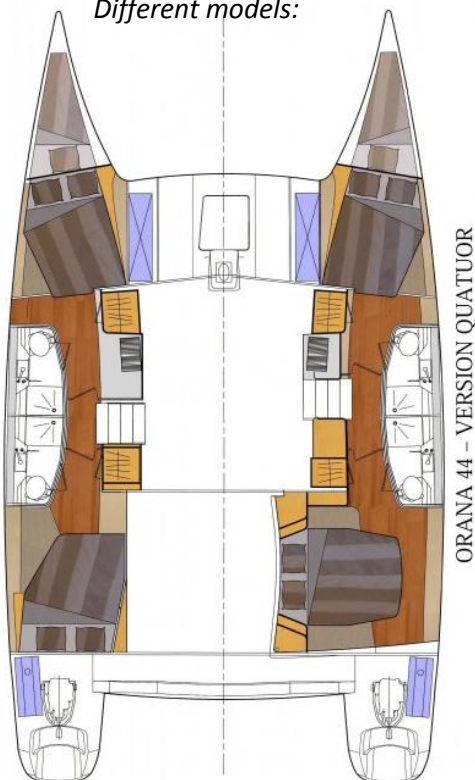







Privilege 445



LOA: 13.45 m (44.12')

Draft: 1.35 m (4.43')

Engine: 2 x 40 HP

Cabins: 6 persons in 3 cabins

LWL: 12.85 m (42.15')

Disp.: 8.900 kg (19.620 lbs)

Beam: 7.07 m (23.20')

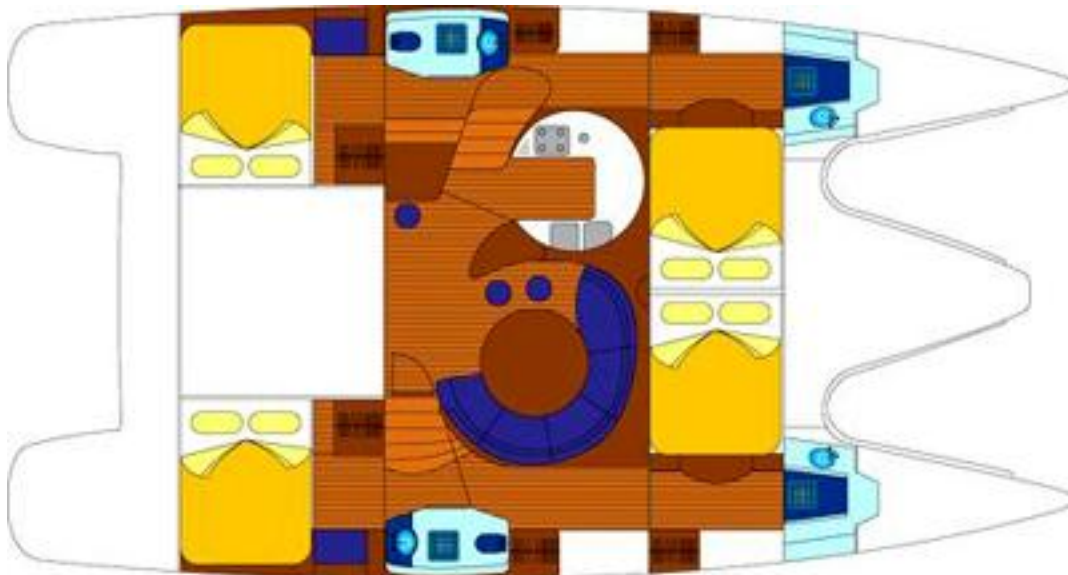





Privilege 495



LOA: 14.95 m (49')
Draft: 1.35 m (4.43')
Engine: 2 x 55 HP

LWL: 14.04 m (46') Beam: 7.33 m (24')
Disp.: 11.300 kg (24.910 lbs)
Cabins: 6 to 8 persons in 3 to 4 cabins

Different models:

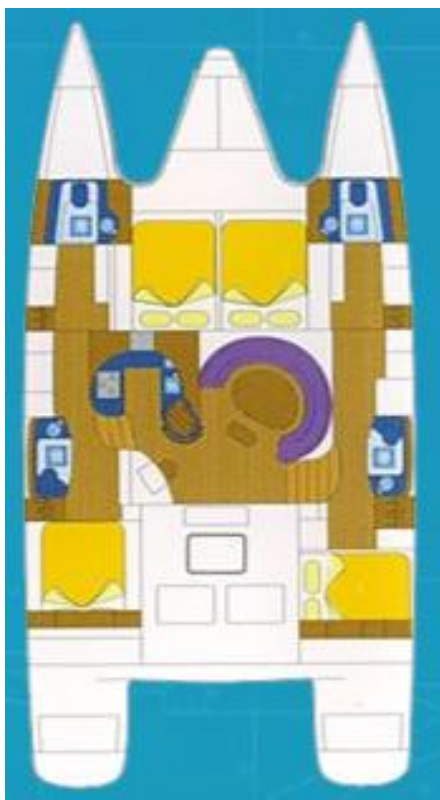





Lagoon 45



LOA: 13.61 m (45')

Draft: 1.30 m (4' 3")

Engine: 2 x 40 HP

Cabins: 6 to 8 persons in 3 to 4 cabins

Beam: 7.70 m (25.26')

Disp.: 12.150 kg (26.800 lbs)

Different models:

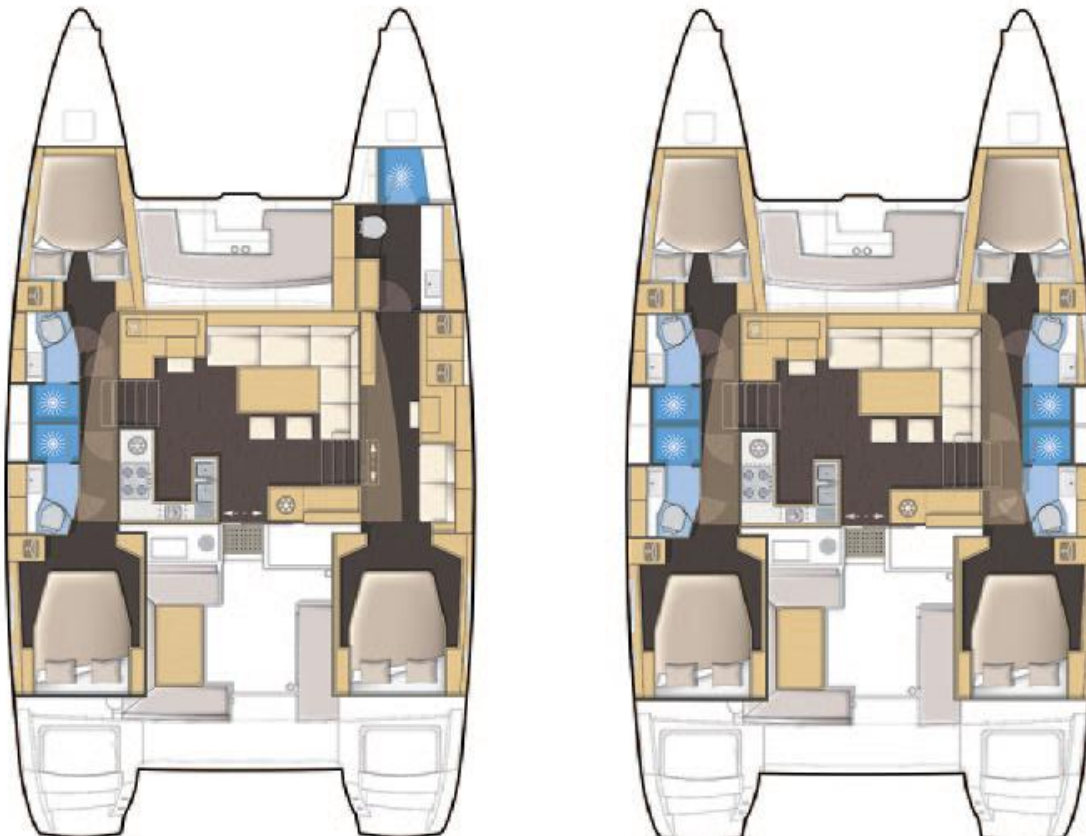









Lagoon 50



LOA: 15.54 m (51')

Draft: 1.40 m (4' 7")

Engine: 2 x 55 HP

Cabins: 6 to 9 persons in 3 to 5 cabins

Beam: 8.53 m (28')

Disp.: 17.070 kg (37.700 lbs)

Different models:



www.sea-and-yachting.com



Advanced.shipbuilding@hotmail.com



Sea.yachting@telenet.be







Exclusive Sail yachts

Fountaine Pajot Eleuthera 60



LOA: 18.28 m (60')
Draft: 1.45 m (4.75')
Engine: 2 x 75 HP

Beam: 8.57 m (28')
Disp.: 18.000 kg (39.700 lbs)
Cabins: 6 to 8 persons in 3 to 4 cabins

Different models:

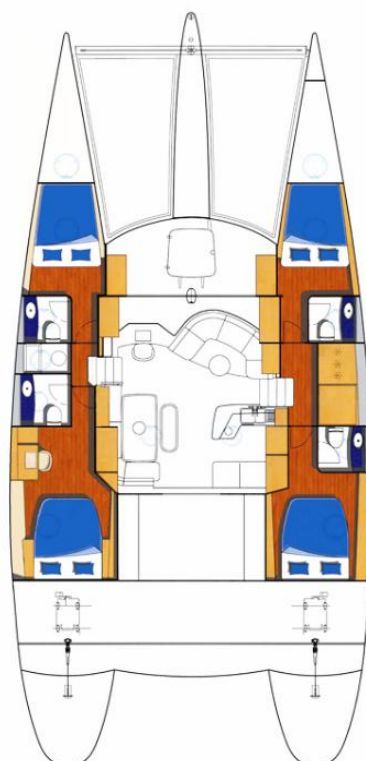





Fountaine Pajot 65



LOA: 19.67 m (65.53')
Draft: 1.41 m (4.62')
Cabins: 11 to 16 persons in 5+1 to 6+2cabins

Beam: 9.50 m (31.16')
Engine: 2 x 110 HP

Different modes:

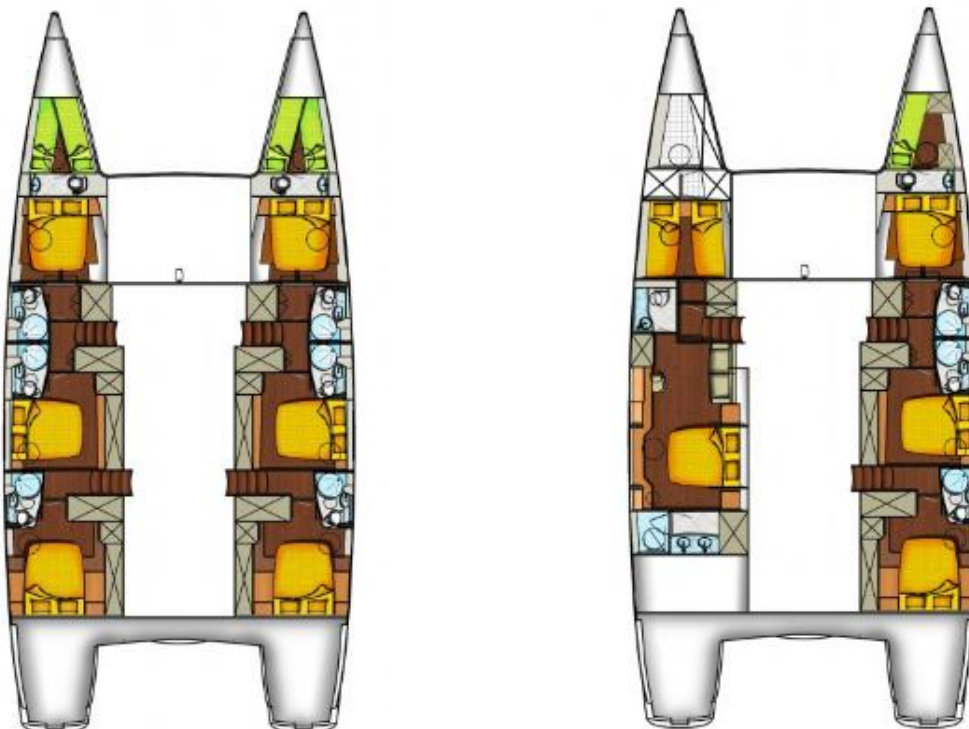







Privilege 615



LOA: 18.50 m (60.60')

Draft: 1.78 m (5.80')

Engine: 2 x Volvo diesel 110 HP

Cabins: 8 to 12 persons in 4 to 6 cabins

LWL: 17.35 m (56.90')

Disp.: 26.500 kg (24.910 lbs)

Beam: 9.25 m (30.30')

Different models:

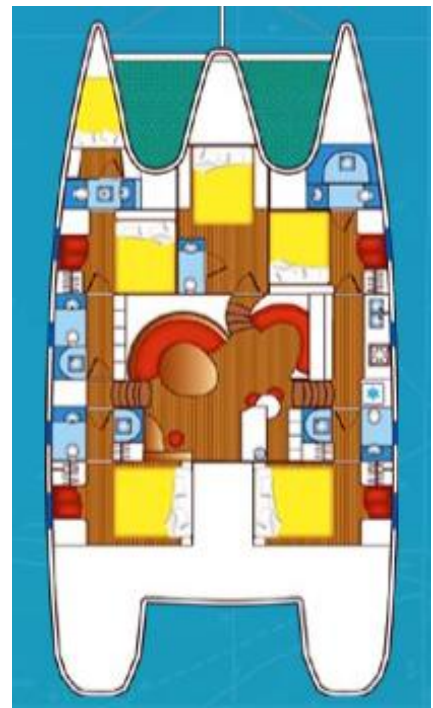
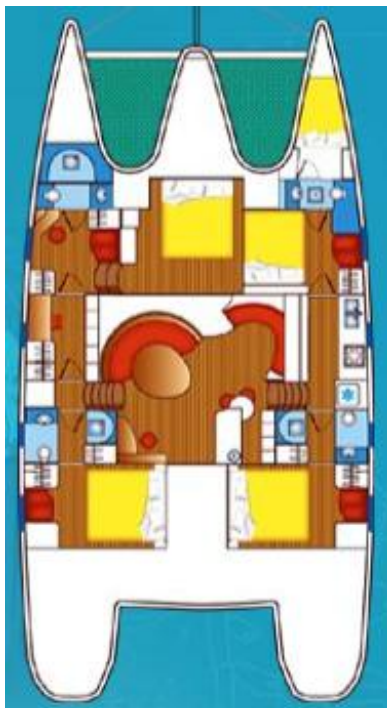
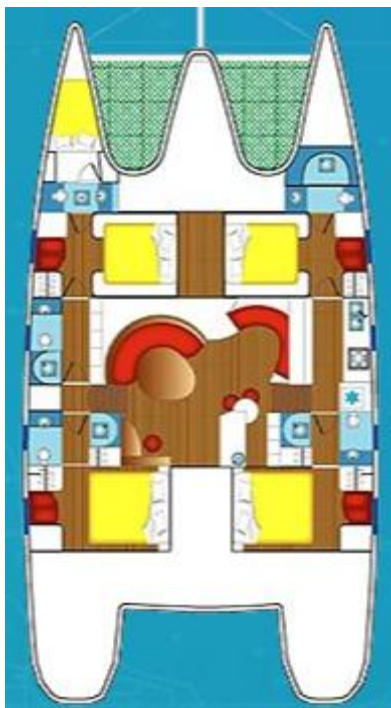



Owners suite on certain models:



Regular room:





Privilege 745



LOA: 22.70 m (72')
Draft: 2.20 m (7.20')
Engine: 2 x 200 HP

LWL: 21.60 m (70.80')
Disp.: 40.000 kg (80.000 lbs)

Beam: 10.90 m (35.70')

Cabins: 7 to 11 persons in 3+1 to 5 +1 cabins

Different models:







Master bedroom on some models:



Normal bedroom:







Lagoon 62



LOA: 18.90 m (62')

Draft: 1.55 m (5' 1")

Engine: 2 x 110 HP

Cabins: 6 to 9 persons in 3 to 5 cabins

Beam: 10 m (32' 10")

Disp.: 27.000 kg (59.500 lbs)

Different models:









Catana 65



LOA: 20.30 m (66' 6)
Draft: 1.20 to 2.95 m (4 to 9.68') board up / down
Engine: 2 x 110 HP
Cabins: 8+1 persons in 4 +1 cabins

Beam: 9.60 m (31' 5)
Disp.: 22.100 kg (48.700 lbs)











Catana 92



LOA: 30 m (98' 5)
Draft: 1.65 to 4.35 m (5'5 to 14'3) board up / down
Engine: 2 x 315 HP
Cabins: 12 persons in 6 cabins

Beam: 12.50 m (41')
Disp.: 32.800 kg (72.300 lbs)













Sunreef 70



LOA: 21.34 m (70')

Draft: 1.80 m (5.91')

Engine: 2 x 160 HP

Cabins: 6+4 to 8+2 persons in 3 double + 4 single to 4 double + 2 single cabins

Beam: 10.40 m (34.12')

Disp.: 34.000 kg (75.000 lbs)

Different models:

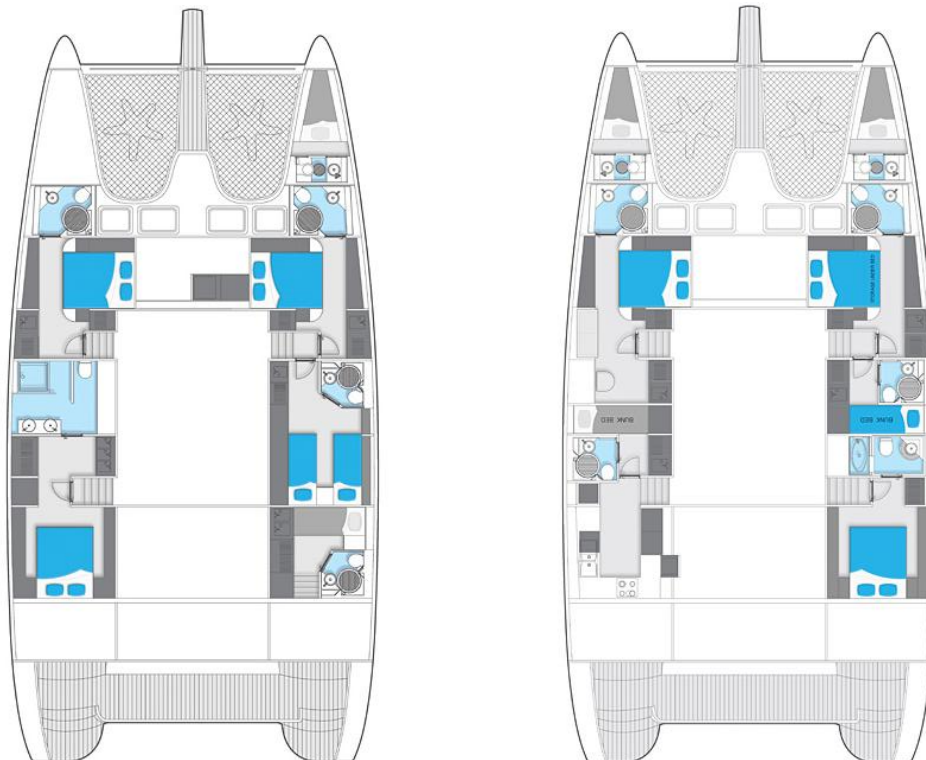







Sunreef 102 Double Deck



LOA: 31.09 m (102')

Draft: 2.50 m (8.20')

Engine: 2 x 455 HP

Cabins: 14+1 persons in 7 double + 1 single cabins

Beam: 12 m (39.37')

Disp.: 120.000 kg (264.500 lbs)

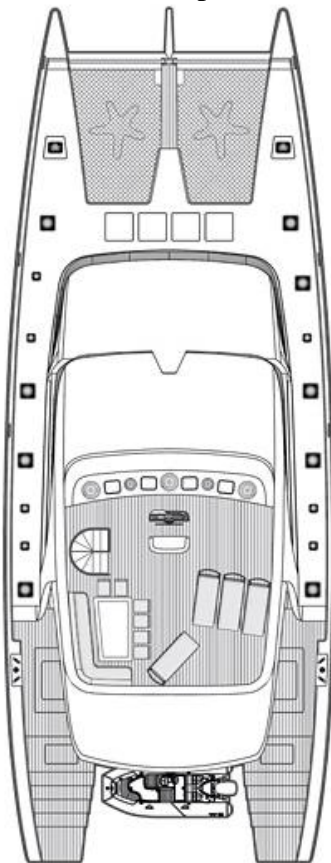

www.sea-and-yachting.com

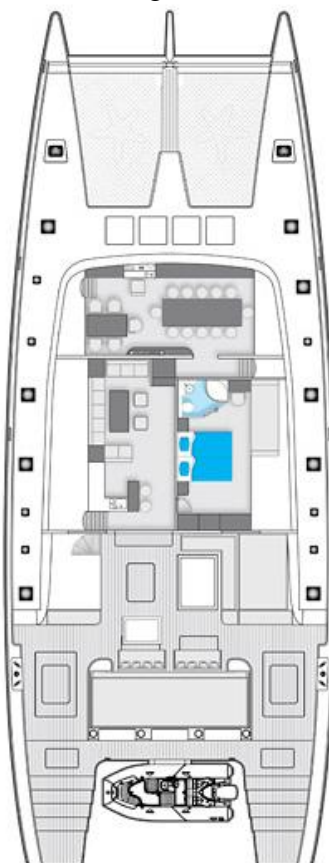

Advanced.shipbuilding@hotmail.com



Sea.yachting@telenet.be











Sunreef 114



LOA: 34.75 m (114')

Draft: 2.90 m (9.51')

Engine: 2 x 455 HP

Cabins: 6+4 persons in 3 double + 4 single cabins

Beam: 12.80 m (42')

Disp.: 120.000 kg (264.500 lbs)

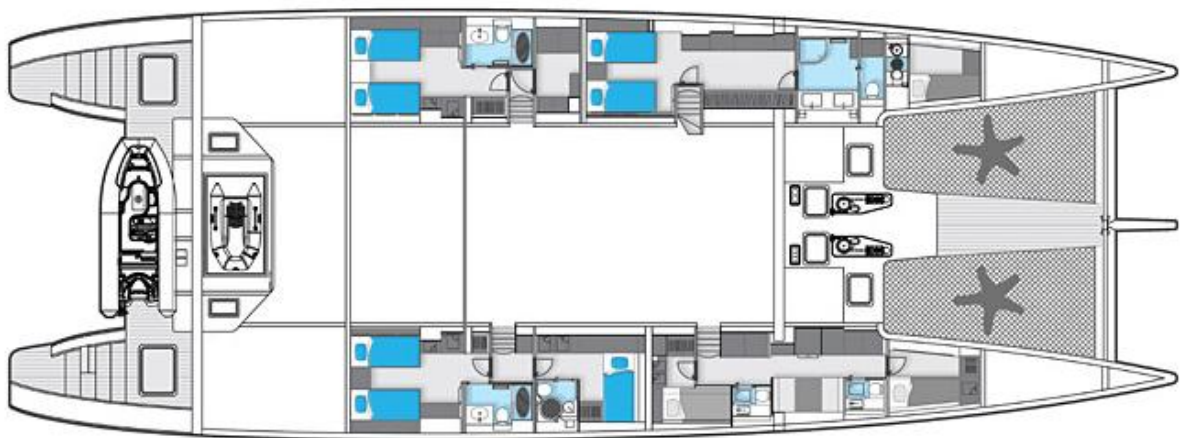
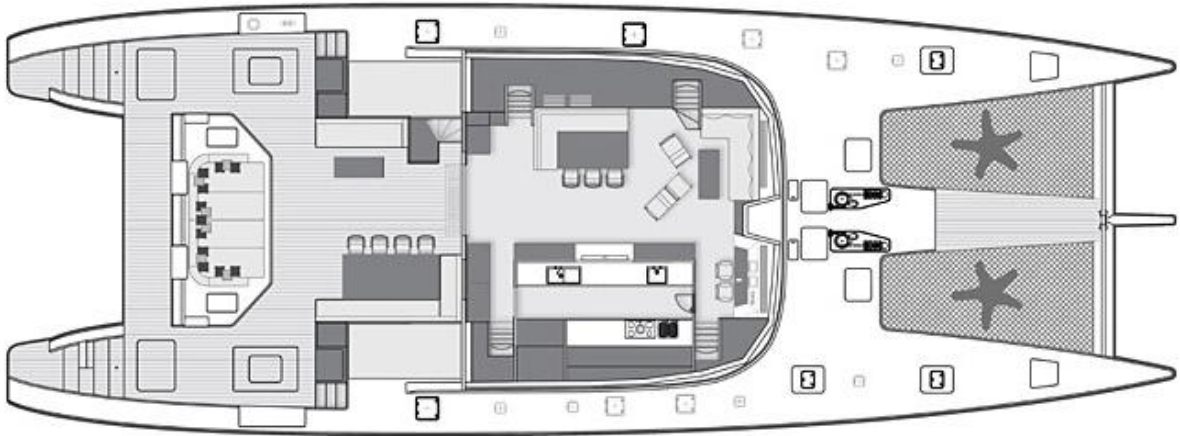









Inhoud

Sport Sail yachts	4
Corsair 36.....	5
Fountaine Pajot Mahe 36	9
Fountaine Pajot Athena 38.....	12
Lagoon 38	15
Luxury Sail yachts	19
Catana 42.....	20
Catana 50.....	25
Fountaine Pajot Orana 44	29
Privilege 445	33
Privilege 495	36
Lagoon 45	39
Lagoon 50	44
Exclusive Sail yachts	48
Fountaine Pajot Eleuthera 60.....	49
Fountaine Pajot 65	52
Privilege 615	56
Privilege 745	60
Lagoon 62	66
Catana 65.....	70
Catana 92.....	75
Sunreef 70	81
Sunreef 102 Double Deck.....	85
Sunreef 114	91

