



ADVANCED  
SHIPBUILDING

CATALOG MOTOR YACHTS



## Introduction:

This catalog is an indication of possible models of motor yachts. There are hundreds of makes and sizes but only 2 very different types. Monohull and multihull yachts, both have a been included in this catalog. This selection has been made to give you an idea of what exists and is possible. Once you have chosen a certain type of model and size we can also, on demand, look into other makes and their nearby sizes.

### Other catalogs:

Catalog of monohull sail yachts

Catalog of multihull sail yachts

Catalog of racing sail yachts

Catalog of powerboats



Timmerman Yvon



Timmerman Rene

# Sport Motor Yachts



# Jeanneau Cap Camarat CC



Several models:

LOA: 5.15 m (16'10") to 6.23 m (20'5")    Beam: 2.12 m (6' 11") to 2.48 m (8'1")

Draft: 0.3 m (0.11') to 0.33 m (1')

Engines:        80 HP 59 kW to 200 HP 147 kW

*Example model 5.1*





*Example model 6.5*



# Jeanneau Cap Camarat DC



Several models:

LOA: 5.43 m (17'9") to 6.47 m (21'2")      Beam: 2.35 m (7' 8") to 2.48 m (8'1")

Draft: 0.3 m (0.11') to 0.33 m (1')

Engines:      120 HP 88 kW to 200 HP 147 kW

*Example model 5.5*



*Example model 6.5*





## Jeanneau Cap Camarat WA



Several models:

LOA: 5.43 m (17'9") to 8.25 m (27')      Beam: 2.36 m (7' 8") to 2.98 m (9'9")

Draft: 0.3 m (0.11') to 0.76 m (2'5")

Engines: 120 HP 88 kW to 400 HP 296 kW

Cabins: 1 cabin ( double berth)

*Example model 5.5*



*Example model 8.5*







## Jeanneau Merry fisher OB (Out board Engine)



Several models:

LOA: 5.75 m (18' 10") to 7.15 m (23' 5")

Beam: 2.40 m (7' 1") to 2.75 m (9')

Draft: 0.3 m (1') to 0.60 m (2')

Engines: 100 HP 74 kW to 150 HP 110 kW

Cabins: 1 cabin (2 to 4 persons dependable on model)

*Example model 585*

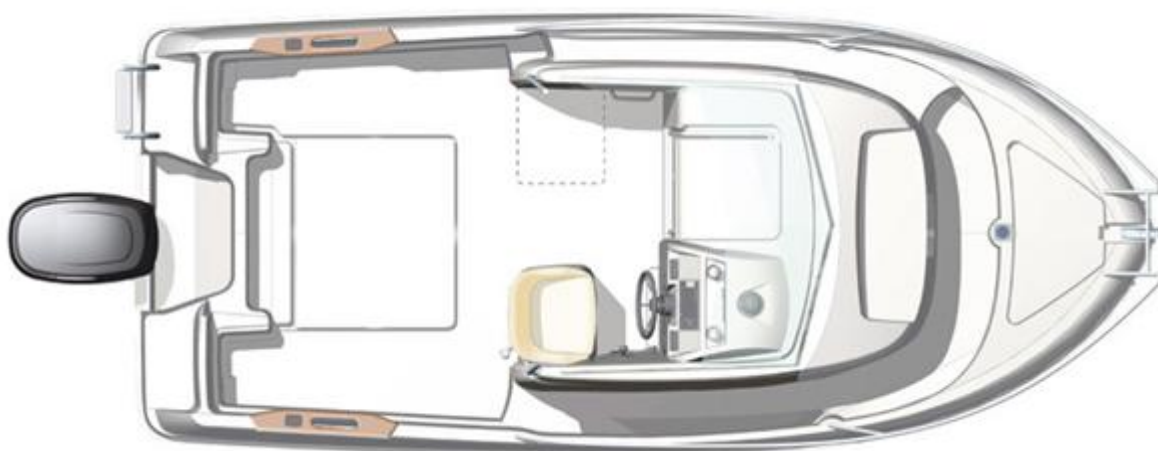



## Jeanneau Merry fisher IB (In board Engine)



Several models:

LOA: 7.53 m (24' 8") to 10.22 m (33' 6") Beam: 2.77 m (9' 1") to 3.33 m (10'11")

Draft: 0.75 m (2'5") to 0.76 m ( 2'5")

Engines: 150 HP 110 kW to 400 HP 296 kW

Cabins: 1 to 2 cabin ( 3 to 6 persons)

*Example model 705*

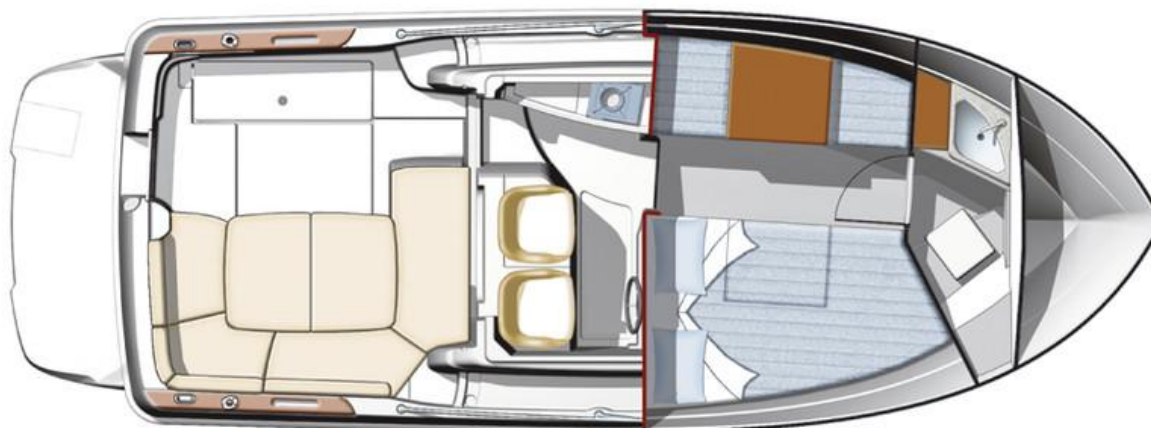



*Example: model 10*







*Model 10 exterior:*





## Carver Super Sport 36 (also in 38')



LOA: 11.66 m (38' 6")      Beam: 4.64 m (13' 1")      Draft: 0.94 m (37")  
 Displ: 9,888 kg (21.800 lb) (loaded)  
 Engines: choice of    Crusader                    2x 330 hp ; 375 hp or 385 hp (Gasoline)  
                                  Yanmar Marine            2x 315 hp (Diesel)  
                                  Volvo Penta                2x 300 hp ; 370 hp or 435 hp (Diesel)  
 Cabins:                1 or 2 cabins ( 2 to 4 persons) depends on model

*Standard model:*



*Optional model:*

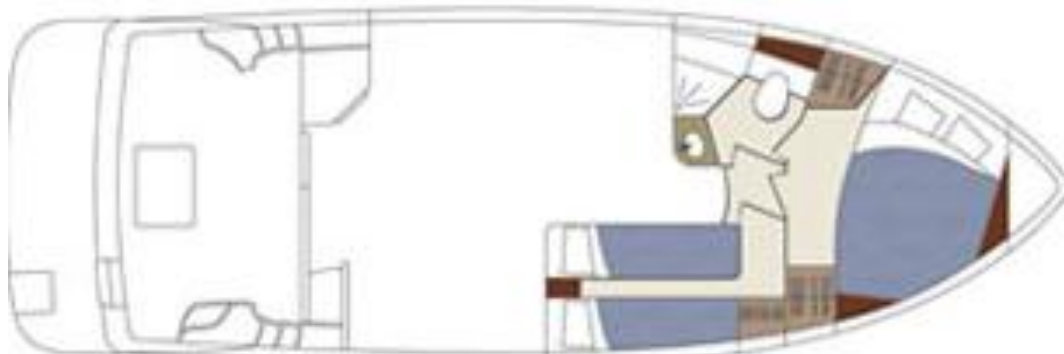







*Second cabin on optional 2 cabin model:*





## Fountain Pajot 35 Pilot



LOA: 10.35 m (34' )      Beam: 4.45 m (14.6' )      Draft: 0.95 m (3.1')  
Engines: choice of Volvo 2x 75 hp or 110 hp  
Cabins:      2 to 3 cabins ( 4 to 6 persons) depends on model

*2 cabin model:*

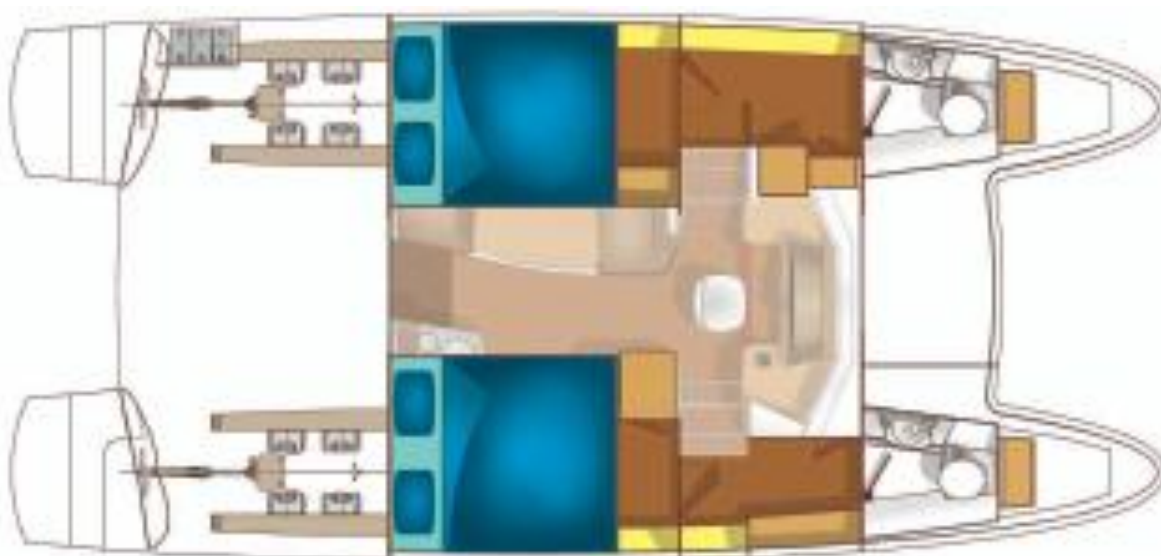

*3 cabin model:*

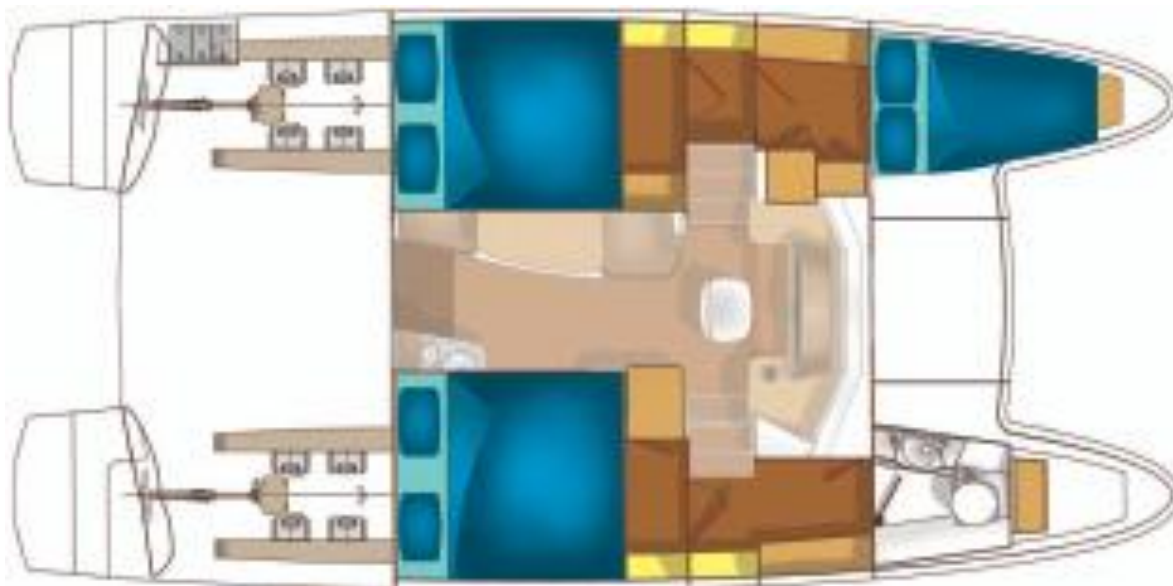







# Sportive Luxury Motor Yachts

# Jeanneau Leader



Several models:

LOA: 8.95 m (29'4") to 10.85 m (35'7")    Beam: 2.99 m (9'9") to 3.73 m (12' 2")

Draft: 0.55 m (1' 8") to 0.90 m ( 2'9")

Engines:        1x 260 HP to 2x 280 HP (depends on model)

Cabins:         1 cabin ( double berth)





*Example Leader 8*

*Example Leader 10*





# Jeanneau NC11



LOA: 10.85 m (35'7")

Beam: 3.73 m (12'2")

Draft: 0.9 m (2'9")

Engines: Volvo 2x 200 HP 149 kW

Cabins: 2 cabins (4 persons)











## Carver 36 Mariner



LOA: 11.50 m (37' 9")      Beam: 3.80 m (12' 5")      Draft: 0.94 m (37")  
 Displ: 8,845 kg (19,500 lb) (loaded)  
 Engines: choice of    Crusader                    2x 330 hp or 375 hp (Gasoline)  
                                  Yanmar Marine                2x 315 hp (Diesel)

Cabins:            1 cabin ( 2 persons)

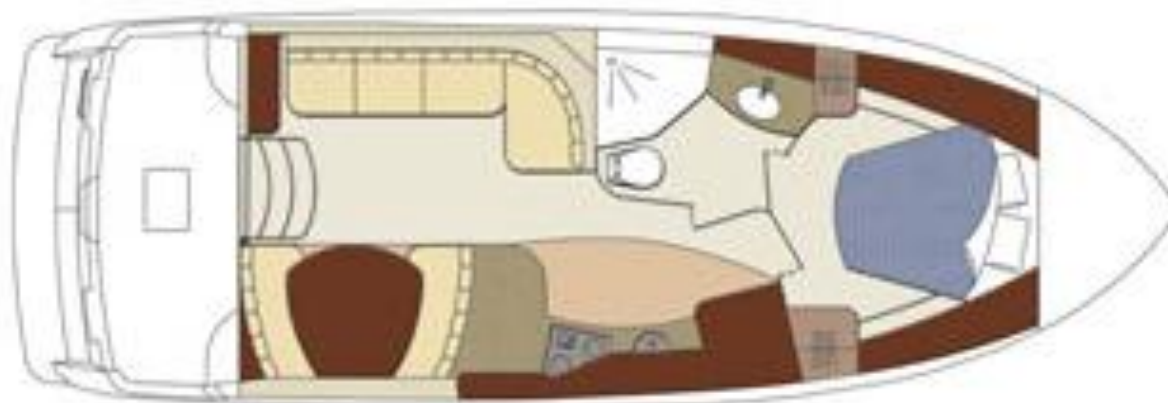







## Carver 41 Cockpit



LOA: 13.08 m (42' 11")      Beam: 4.09 m (13' 5")      Draft: 0.79 m (31")  
 Displ: 11,793 kg (26.000 lb) (loaded)  
 Engines: choice of    Crusader                    2x 330 hp or 385 hp (Gasoline)  
                                  Yanmar Marine            2x 315 hp (Diesel)  
                                  Volvo Penta                 2x 370 hp (Diesel)

Cabins:            2 cabin ( 4 persons)











## Carver 43 Super Sport



LOA: 13.28 m (43' 7")      Beam: 4.24 m (13' 11")      Draft: 1.17 m (46")

Displ: 15,263 kg (33,650 lb) (loaded)

Engines: choice of	Crusader	2x 385 hp (Gasoline)
	Yanmar Marine	2x 440 hp (Diesel)
	Volvo Penta	2x 370 hp or 435 hp (Diesel)
	Volvo Penta	2x 400 hp (Gas)

Cabins:      2 cabin ( 4 persons)



















## Riva SportRiva 56



LOA: 17.57 m (57' 8")

LWL: 14.19 m (46' 7")

Beam: 4.64 m (15' 3")

Draft: 1.40 m (4' 7")

Displ: 29,710 kg (65,499 lb) (loaded)

Engines: MAN V8 2x 900 HP 662 kW

Cabins: 4 cabins ( 7 to 8 persons)

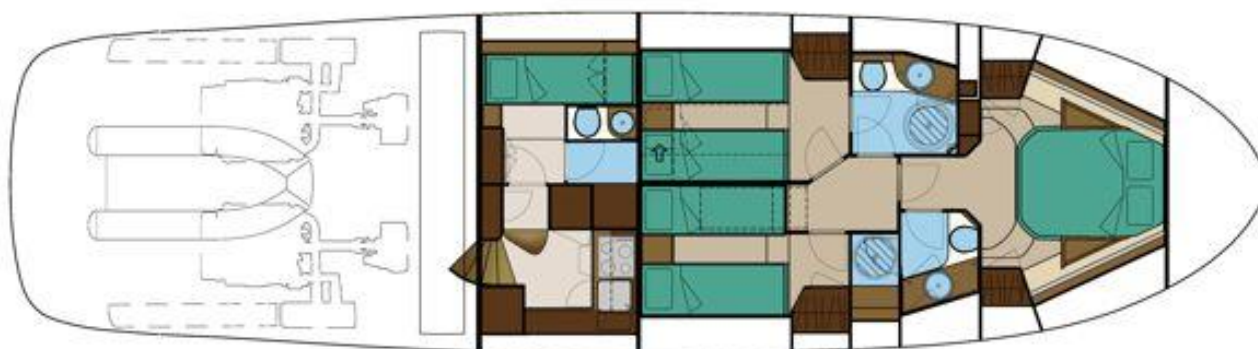







# Luxury Motor Yachts

## Etap 1100ac



LOA:	11 m (33')	LWL:	9.25 m	Beam:	3.37 m
Draft:	1 m (3')	Displ:	9,500kg (20,944lb)		
Engines:	Choice of Yanmar		1x 100HP ; 160 HP (standard) ; 240 HP ; 315 HP		
	Volvo Penta		2x 160 HP ; 2x 190 HP		
Cabins:	2 cabin ( 4 persons)				

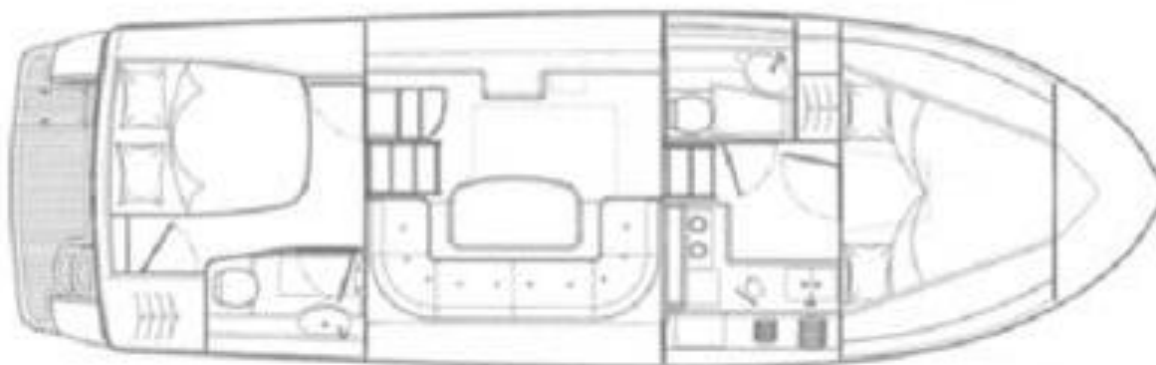











## Oyster LD 43



LOA: 13.26 m (43')

Beam: 4.09 m (13')

Draft: 0.68 m (2')

Displ: 9,500 kg (20,944lb)

Joinery: Teak

Cabins: 1 cabin ( double berth)

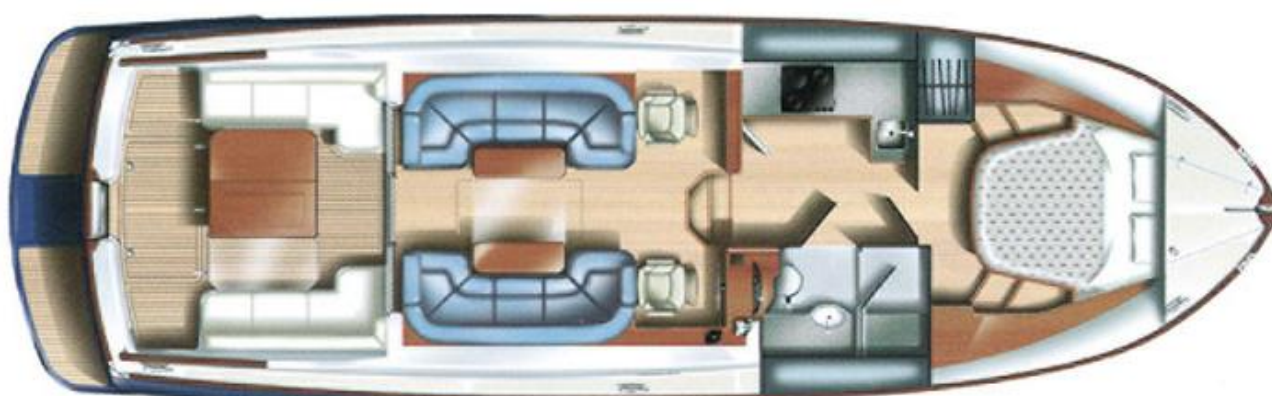









## Carver 46



LOA: 14.30 m (46' 11")      Beam: 4.55 m (14' 11")      Draft: 1.08 m (43")  
Displ: 19,731 kg (43,500 lb) (loaded)  
Engines: choice of    CAT      2x 575 hp (Diesel)  
                              Volvo Penta    2x 500 hp or 575 hp (Diesel)

Cabins:      2 cabin ( 4 persons)

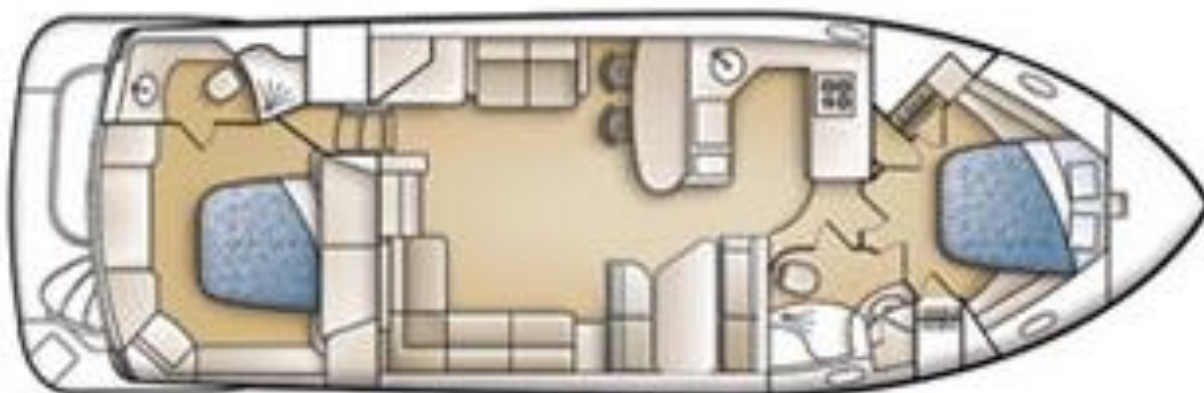









## Riva Vertigo 63



LOA: 19.57 m (64' 2")      LWL: 15.62 m (51'3")      Beam: 4.80 m (15' 9")  
 Draft: 1.60 m (5' 3")      Displ: 32,890 kg (72.510 lb) (loaded)  
 Engines:      MAN V12      2x 1360 HP 1000 kW  
 Cabins:      3 cabins ( 6 persons) + 1 Crew

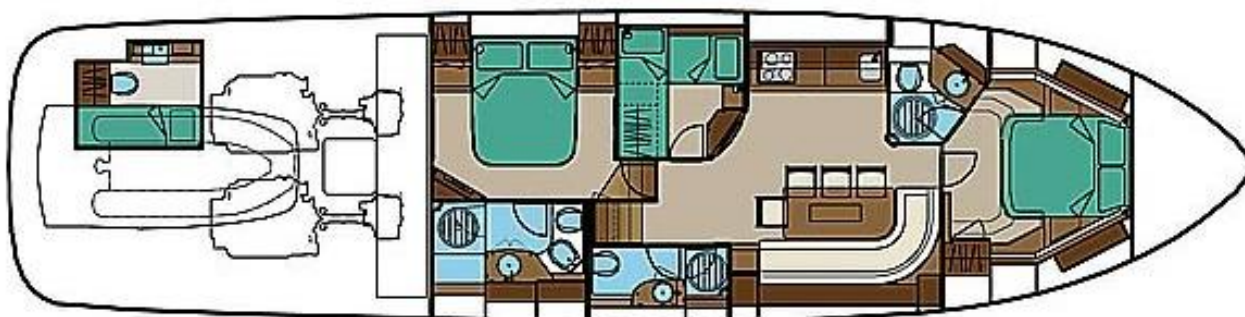







# Exclusive Motor Yachts



## Carver 47



LOA: 14.99 m (49' 2")      Beam: 4.32 m (14' 2")      Draft: 1.07 m (42")  
 Displ: 16.244 kg (35.811 lbs) (loaded)  
 Engines: choice of    CAT                      2x 460 hp (Diesel)  
                             Crusader                2x 385 hp (Gas)  
                             Volvo Penta            2x 370 hp or 435 hp (Diesel)  
                             Yanmar Marine        2x 480hp (Diesel)

Cabins:            2 cabin ( 4 persons)













## Carver 56 Voyager SE



LOA: 18.20 m (59' 8")      Beam: 4.70 m (15' 4")      Draft: 1.45 m (57")  
 Displ: 23.814 kg (52.500 lbs) (loaded)  
 Engines: choice of    CAT      2x 715 hp (Diesel)  
                              Volvo Penta    2x 500 hp, 575 hp or 675 hp (Diesel)

Cabins:      3 cabin ( 6 persons)

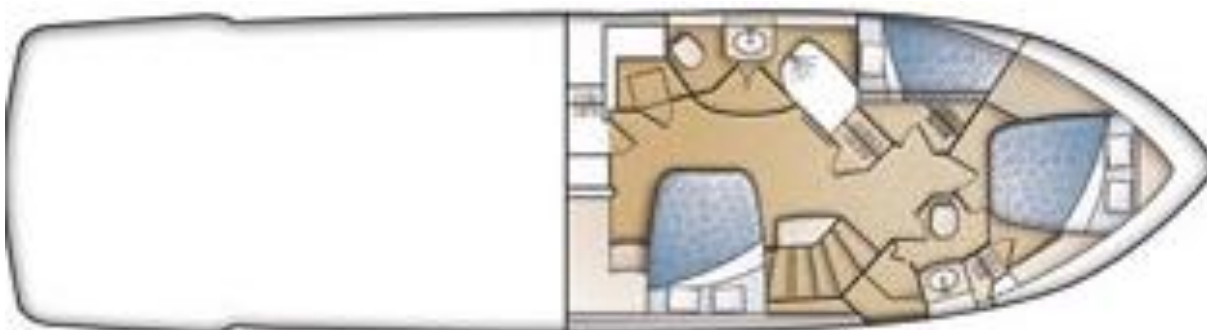











## Riva 68 Ego Super



LOA: 20.82 m (68' 4")      LWL: 17.31 m (56' 9")      Beam: 5.45 m (17' 11")  
Draft: 1.85 m (6' 1")      Displ: 42,000 kg (92.594 lb) (loaded)  
Engines:      MTU V10      2x 1623 HP 1193 kW  
Cabins:      3 cabins ( 6 persons) + 1 Crew

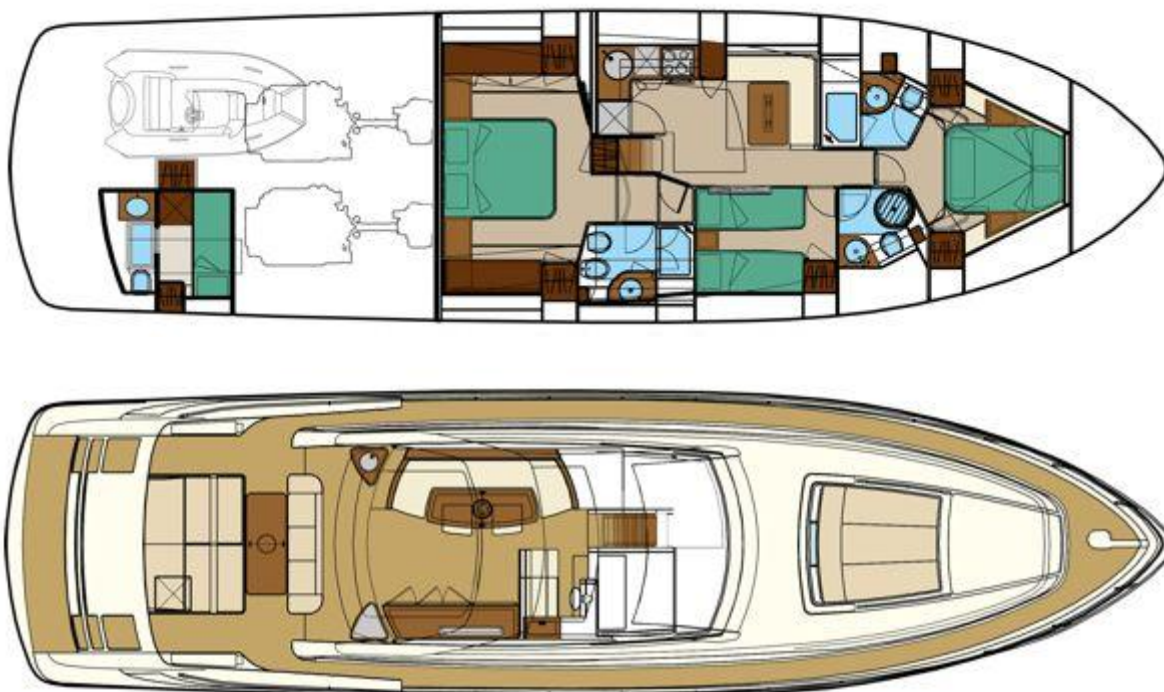













# Riva Venere 75



LOA: 23.00 m (75' 6")      LWL: 19.10 m (62' 8")      Beam: 5.72 m (18' 9")  
 Draft: 1.86 m (6' 1")      Displ: 58,200 kg (128.309 lb) (loaded)  
 Engines:      MTU V10      2x 1524 HP 1120 kW  
                   MTU V10      2x 1623 HP 1193 kW  
 Cabins:      3 to 4 cabins ( 6 to 8 persons) + 2 Crew berths

*Standard version:*

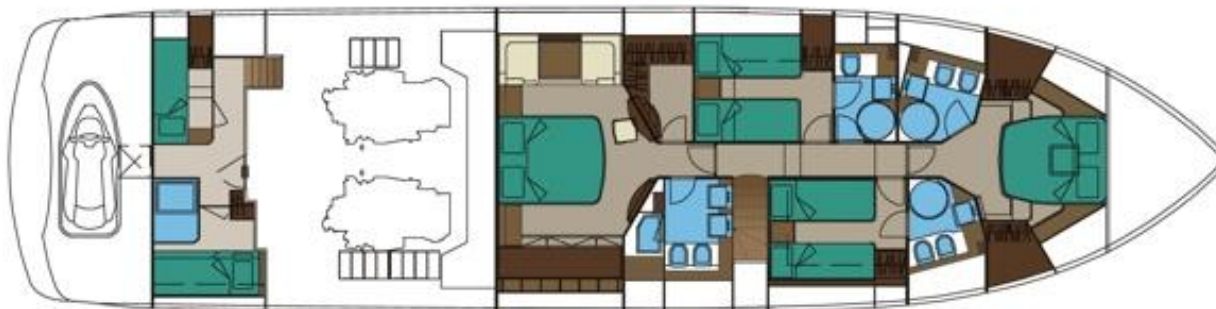

*Optional version:*













## Fountain Pajot Queensland 55



LOA: 17.25 m (56.6')      LOA: 15.85 m (52')      Beam: 7.80 m (25.6')  
 Draft: 1.10 m (3.6')      Displ.: 22.000 kg (48.500 lbs)  
 Engines: choice of Volvo 2x 435 hp or 670 hp  
 Cabins:      2 to 3 cabins ( 4 to 6 persons) depends on model

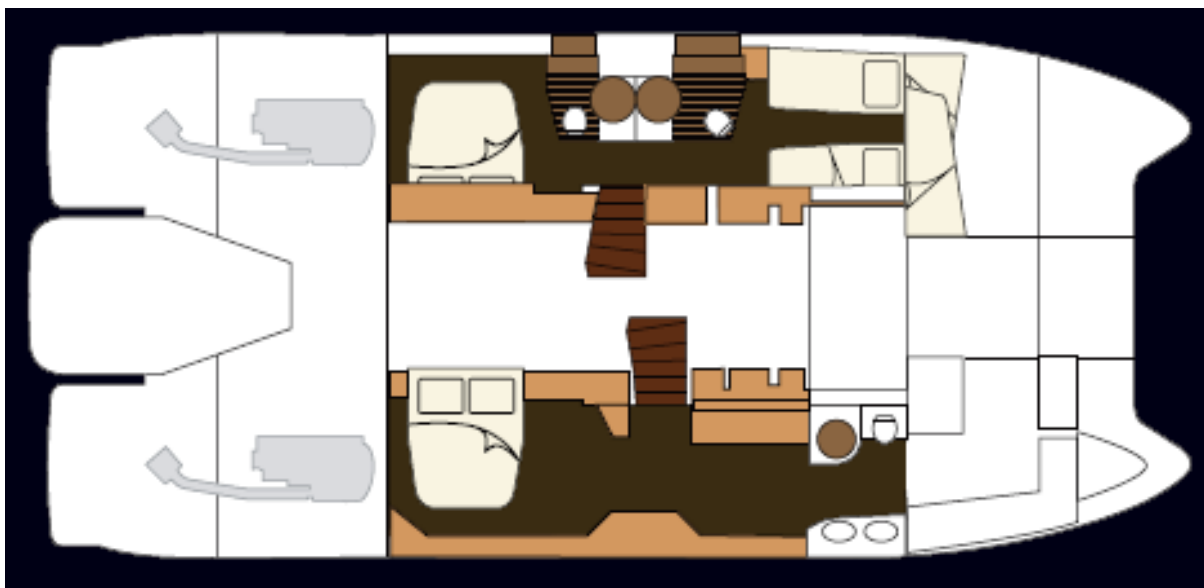

















# Supreme Motor Yachts

## Sunreef 70 Power (also in 60' and 85')



LOA: 21.34 m (70')      Beam: 7.80 m (25.6')      Draft: 1.45 m (4.76')  
Displ.: 45.000 kg  
Engines: choice of Volvo 2x 455 hp - 870 hp  
Cabins:      7 to 9 cabins ( 13 to 16 persons) depends on model

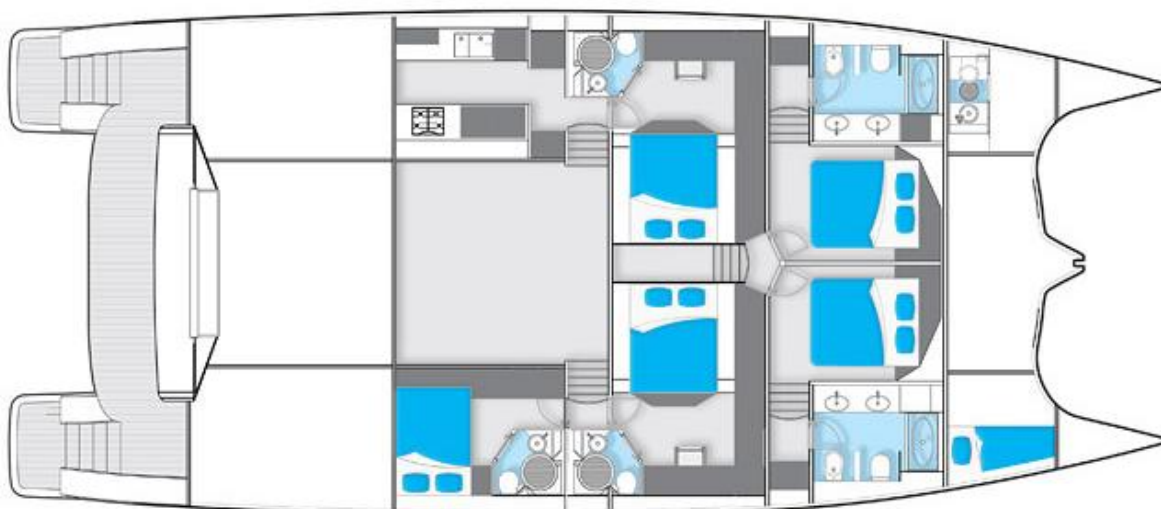



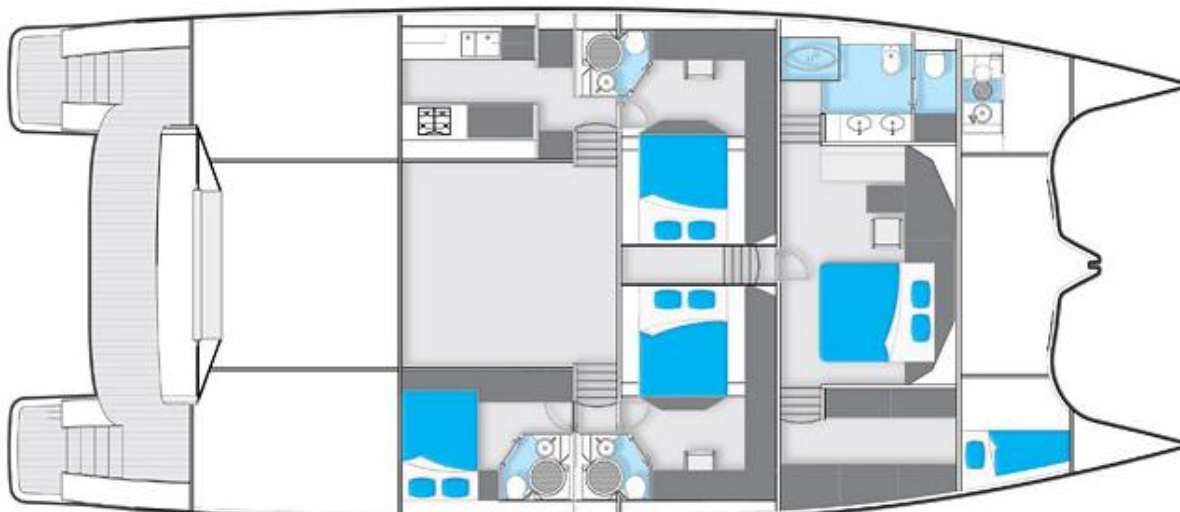

*Main deck*

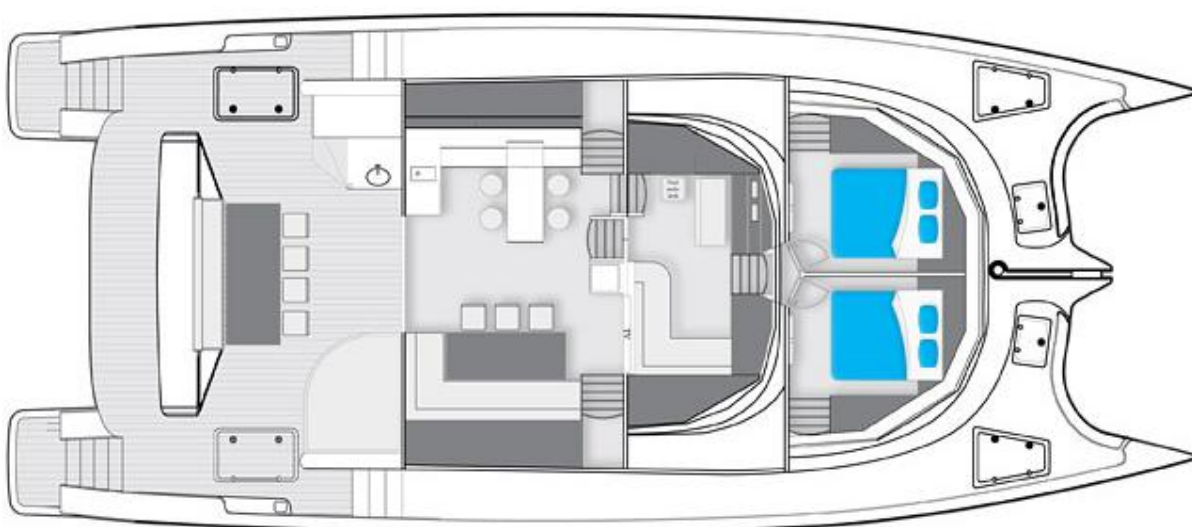

*Upper deck*

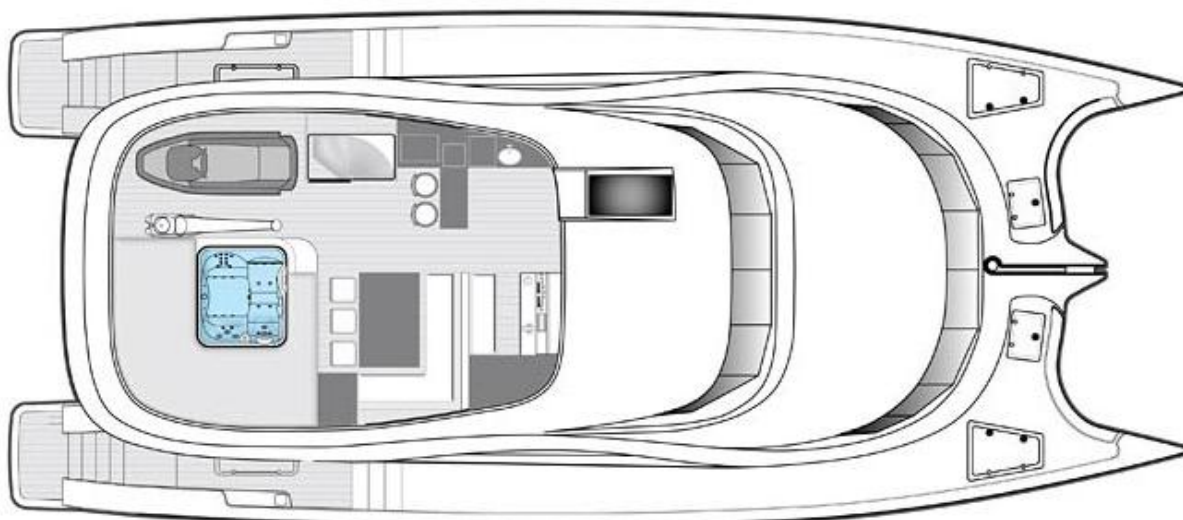

























# Riva Opera Super 85



LOA: 26.02 m (85' 4")      LWL: 20.90 m (68' 7")      Beam: 6.20 m (20' 4")  
 Draft: 1.86 m (6' 1")      Displ: 80,700 kg (177.913 lb) (loaded)  
 Engines:      MTU V12      2x 1948 HP 1432 kW  
 Cabins:      4 cabins ( 8 persons) + 3 to 4 Crew berths

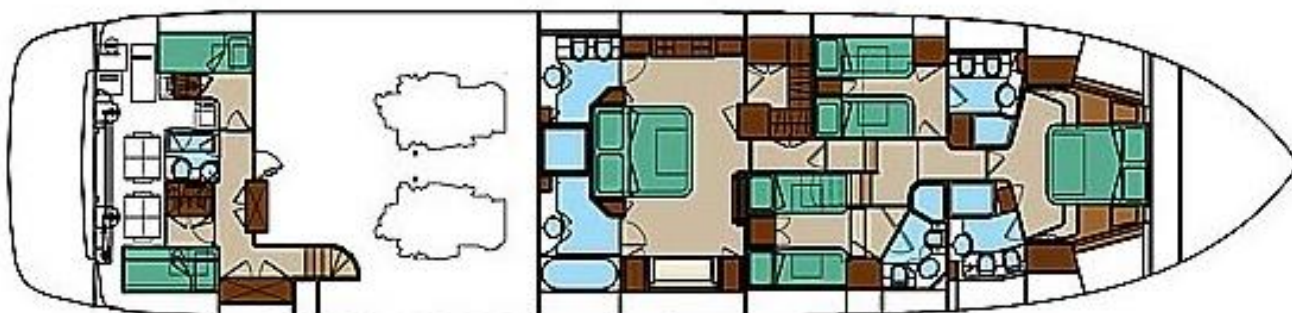



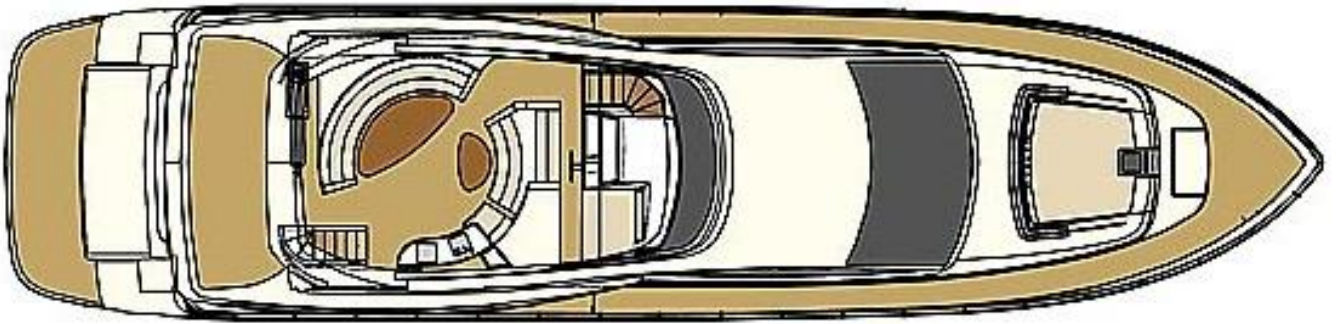









## Riva Domino 86



LOA: 26.40 m (86' 7")

LWL: 20.60 m (67' 7")

Beam: 6.20 m (20' 4")

Draft: 1.82 m (6')

Displ: 75,200 kg (165.788 lb) (loaded)

Engines: MTU V16 2x 2435 HP 1792 kW

Cabins: 5 cabins ( 10 persons)



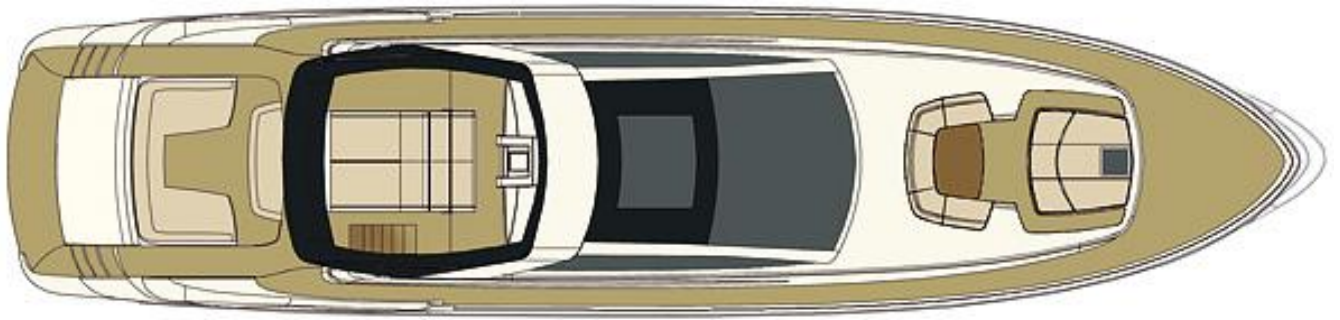









## Riva Duchessa 92



LOA: 28.23 m (92' 7")      LWL: 23.61 m (75' 6")      Beam: 6.75 m (22' 2")  
 Draft: 2.30 m (7' 6")      Displ: 103,000 kg (227.076 lb) (loaded)  
 Engines:      MTU V16      2x 2218 HP 1630 kW  
                   MTU V16      2x 2435 HP 1792 kW  
 Cabins:      4 cabins lower deck ( 8 persons) + 3 cabins main deck (5 persons)

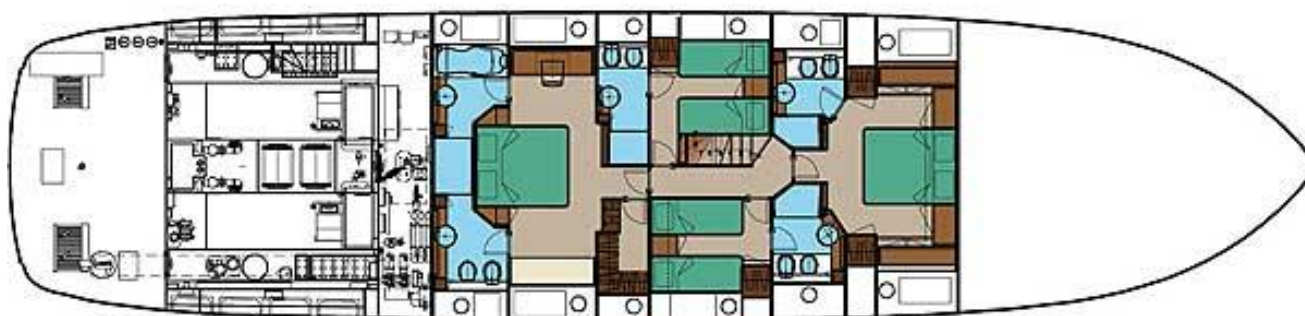

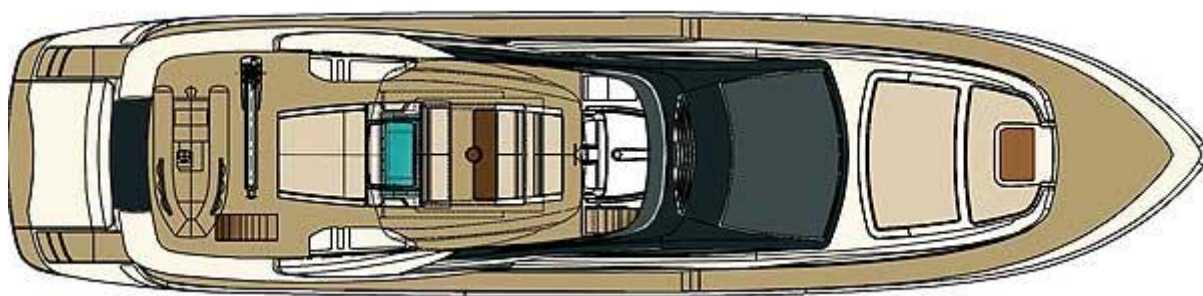









# Riva Athena 115



LOA: 35.40 m (116' 2")      LWL: 29.48 m (96' 9")      Beam: 7.08 m (23' 3")  
 Draft: 2.05 m (6' 9")      Displ: 162,000 kg (357.149 lb) (loaded)  
 Engines:      MTU V12      2x 2775 HP 2040 kW  
 Cabins:      4 cabins lower deck ( 8 persons) +5 Crew  
                  1 master cabins main deck (2 persons)

*Standard version:*

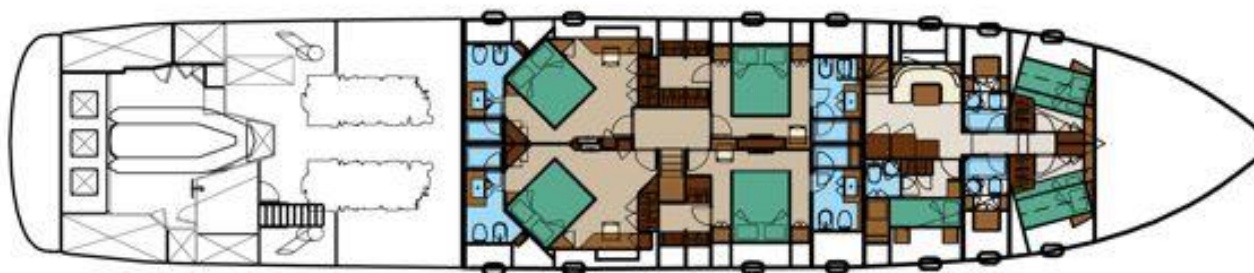

*Optional version:*



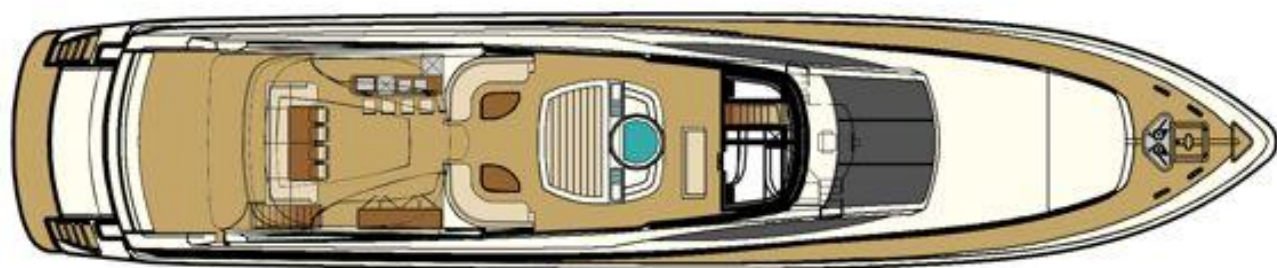











## Heesen 156



LOA: 47.54 m (156' )      Beam: 8.500 m (27' 10" )      Draft: 2.50 m (8' 2" )  
Engines:      Twin MTU 16V 4000 M70  
Cabins:      5 cabins ( 10 persons)

























## Lurssen 223



LOA: 68.00 m (223' )                      Beam: 13.00 m (42' )                      Draft: 3.60 m (12' )  
Engines:        Twin Caterpillar 3512B Diesels  
Cabins:            6 cabins ( 12 persons)  
                      10 cabins for crew (22 persons)























## Oceanco 269



LOA: 82.00 m (269' 1" )      Beam: 14.20 m (46' 7" )      Draft: 3.90 m (12' 10" )  
Engines:      Twin MTU 16V595 TE 70  
Cabins:      6 cabins ( 12 persons)  
            Crew cabins for 26 persons



















## Table of content

Sport Motor Yachts .....	3
Jeanneau Cap Camarat CC.....	4
Jeanneau Cap Camarat DC .....	6
Jeanneau Cap Camarat WA .....	8
Jeanneau Merry fisher OB (Out board Engine) .....	11
Jeanneau Merry fisher IB (In board Engine).....	13
Carver Super Sport 36 (also in 38').....	17
Fountaine Pajot 35 Pilot .....	20
Sportive Luxury Motor Yachts .....	24
Jeanneau Leader.....	25
Jeanneau NC11 .....	29
Carver 36 Mariner .....	32
Carver 41 Cockpit .....	35
Carver 43 Super Sport .....	38
Riva Rivale .....	41
Riva SportRiva 56.....	44
Luxury Motor Yachts .....	47
Etap 1100ac.....	48
Oyster LD 43 .....	52
Carver 46 .....	55
Riva Vertigo 63 .....	58
Exclusive Motor Yachts.....	61
Carver 47 .....	62
Carver 56 Voyager SE .....	66
Riva 68 Ego Super .....	70
Riva Venere 75.....	74
Fountaine Pajot Queensland 55 .....	78

Supreme Motor Yachts.....	84
Sunreef 70 Power (also in 60' and 85') .....	85
Riva Opera Super 85 .....	94
Riva Domino 86 .....	98
Riva Duchessa 92 .....	102
Riva Athena 115 .....	106
Heesen 156.....	111
Lurssen 223.....	119
Oceanco 269.....	126





